

Mounted points

Uses

Wheels with central shank or nut for portable machines, especially manufactured for use in foundries, shipyards or boilermaking. Ideal for the use of materials such as iron, bronze, steel and alloys.

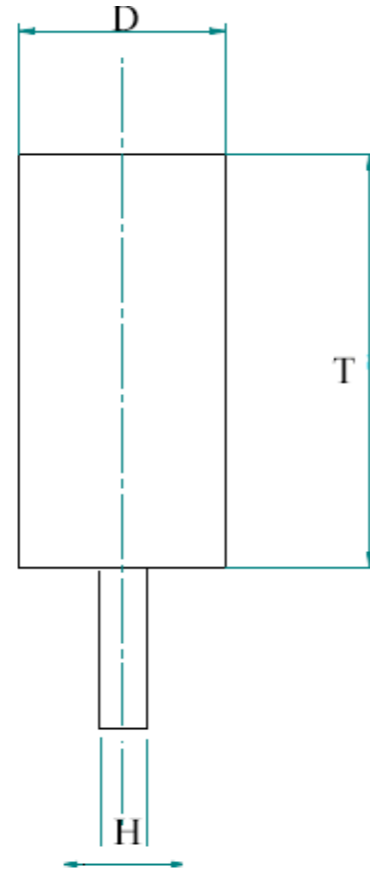
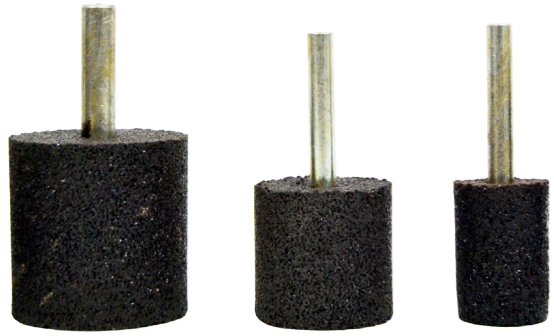

D	H	Eje
10	20	6
15	35	6
20	30	6
20	40	6
30	30	6
30	30	8
30	40	6
30	40	8
40	30	8
40	40	8
50	15	8
50	20	8
50	30	8
50	50	8
60	30	8
* Ask for other sizes		

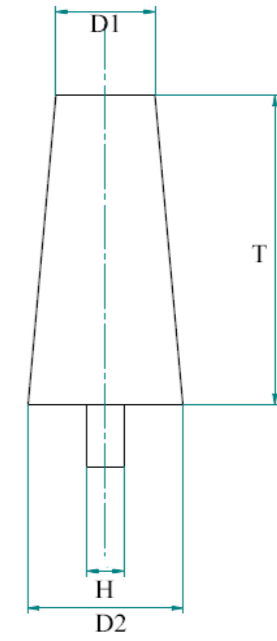

D1/D2	T	H
25/16	50	6
25/16	50	8
30/15	40	6
30/15	40	8
30/20	60	8
* Ask for other sizes		